











A SUBBASEMENT FLOOR PLAN
SCALE: 3/32" = 1'-0"

The subbasement floor plan shows a rectangular structure with a north arrow pointing towards the top right. A scale bar indicates a distance of 16 feet, with intermediate markings at 0, 2, 4, and 8 feet.

DEPARTMENT INDEX: SUB-BASEMENT FLOOR	
BUILDING SUPPORT	6,050 sqft
	<u>6,050 sqft</u>

© 2015 COPYRIGHT GH2 ARCHITECTS, LLC

DECOR CONCRETE — 
 VCT TILE — 
 CARPET — 
 RUBBER — 
 2"x2" CERAMIC TILE — 
 MARBLE — 

DEPARTMENT INDEX: 1ST FLOOR	
	OMES 17,622 sqft
	CONFERENCE ROOM 870 sqft
	BUILDING SUPPORT 4,543 sqft
	23,035 sqft

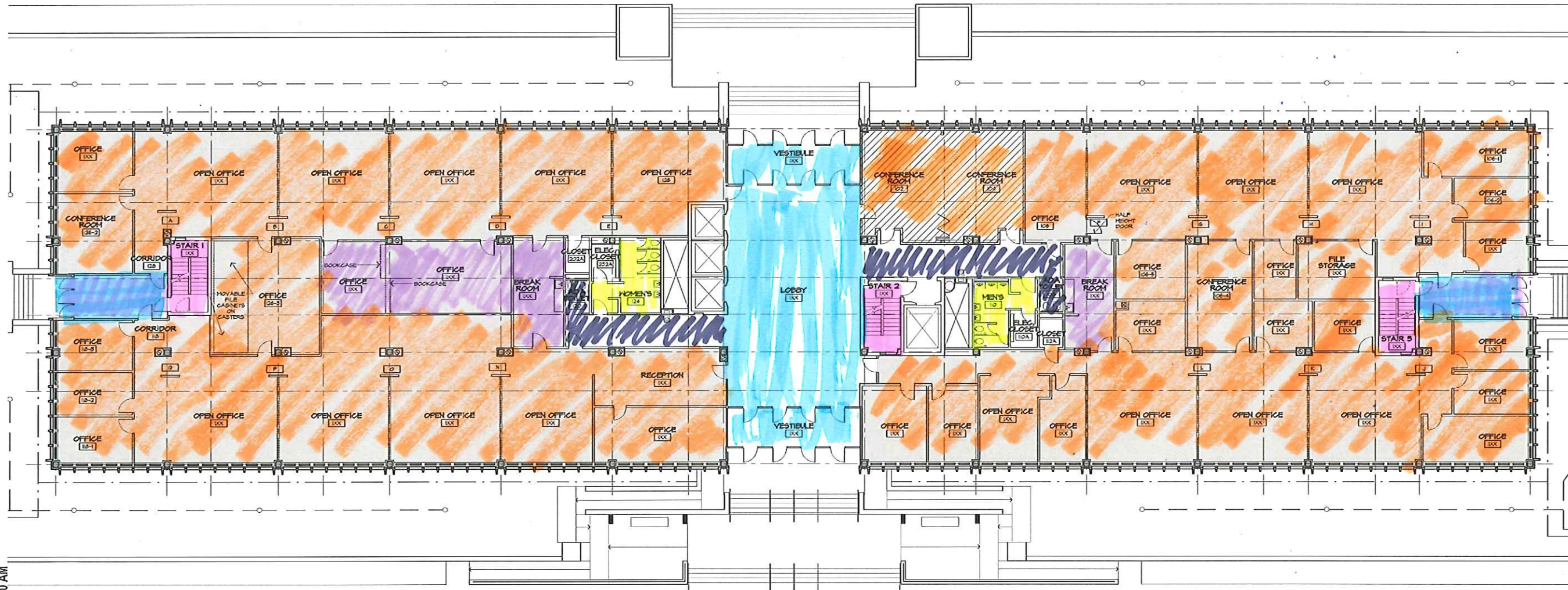

Will Rogers
Existing Conditions
 Oklahoma City, Oklahoma
 Floor Plans

GH2 ARCHITECTS

320 South Boston, Suite 1600
 Tulsa, OK 74103
 T: 918.587.6158 GH2.COM
 A SPECIALTY PRACTICE OF GH2 ARCHITECTS, LLC

INTERIM REVIEW
 ONLY

DOCUMENT INCOMPLETE.
 NOT INTENDED FOR PERMIT,
 BIDDING OR CONSTRUCTION

ARCHITECT: THOMAS C. SEAT
 LICENSE #: 4153

PROJECT #: 20120027.43

ISSUE DATES:
 05/12/14 As-built Review

SHEET NUMBER:

A102

© 2015 COPYRIGHT GH2 ARCHITECTS, LLC

PRINTED: 5/12/2015 10:00 AM

A 1st FLOOR PLAN
 SCALE: 3/32" = 1'-0"
 NORTH 0 2 4 8 16 FEET

PRINTED: 5/12/2015 10:00 AM

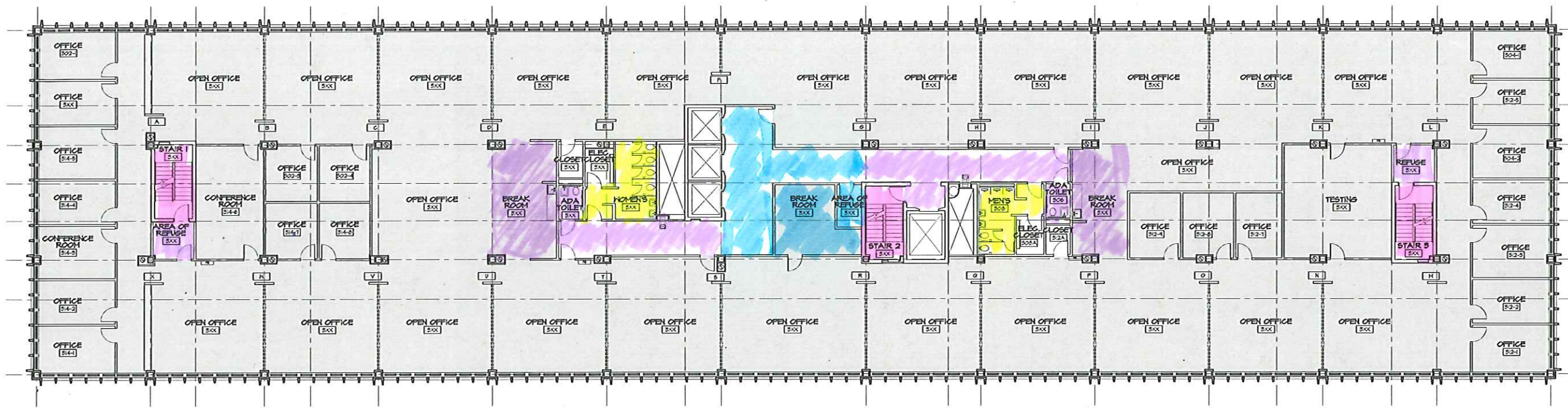

DEPARTMENT INDEX:
3RD FLOOR

□ OESC	20,420 sqft
□ BUILDING SUPPORT	2,910 sqft
	23,330 sqft

B 3rd FLOOR PLAN

SCALE: 3/32" = 1'-0"

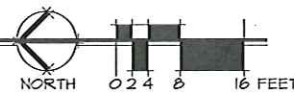

DEPARTMENT INDEX:
2ND FLOOR

□ OMES	15,102 sqft
□ SECRETARY OF STATE	2,988 sqft
▨ CONFERENCE ROOM	1,210 sqft
□ BUILDING SUPPORT	3,430 sqft
	23,330 sqft

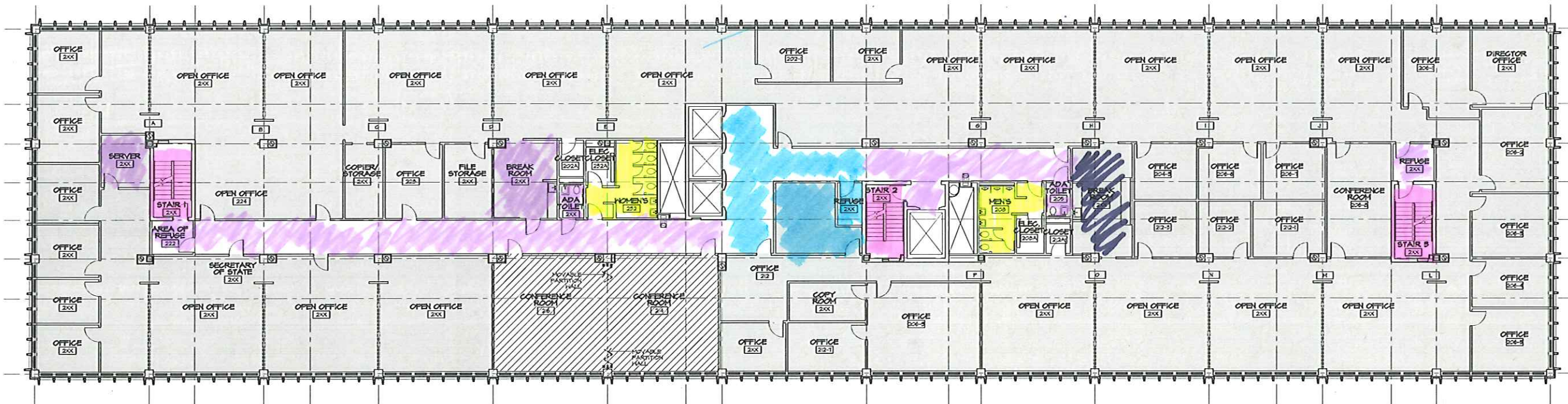

A 2nd FLOOR PLAN

SCALE: 3/32" = 1'-0"

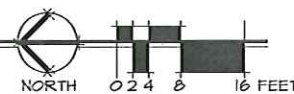

Will Rogers
Existing Conditions
Oklahoma City, Oklahoma
Floor Plans

GH2 ARCHITECTS

320 South Boston, Suite 1600
Tulsa, OK 74103
T: 918.587.6158 GH2.COM
A SPECIALTY PRACTICE OF GH2 ARCHITECTS, LLC

INTERIM REVIEW
ONLY

DOCUMENT INCOMPLETE.
NOT INTENDED FOR PERMIT,
BIDDING OR CONSTRUCTION

ARCHITECT: THOMAS C. SEAT
LICENSE #: 4183

PROJECT #: 20120027.43

ISSUE DATES:
05/12/14 As-built Review

SHEET NUMBER:

A103

© 2015 COPYRIGHT GH2 ARCHITECTS, LLC

PRINTED: 5/12/2015 10:01 AM

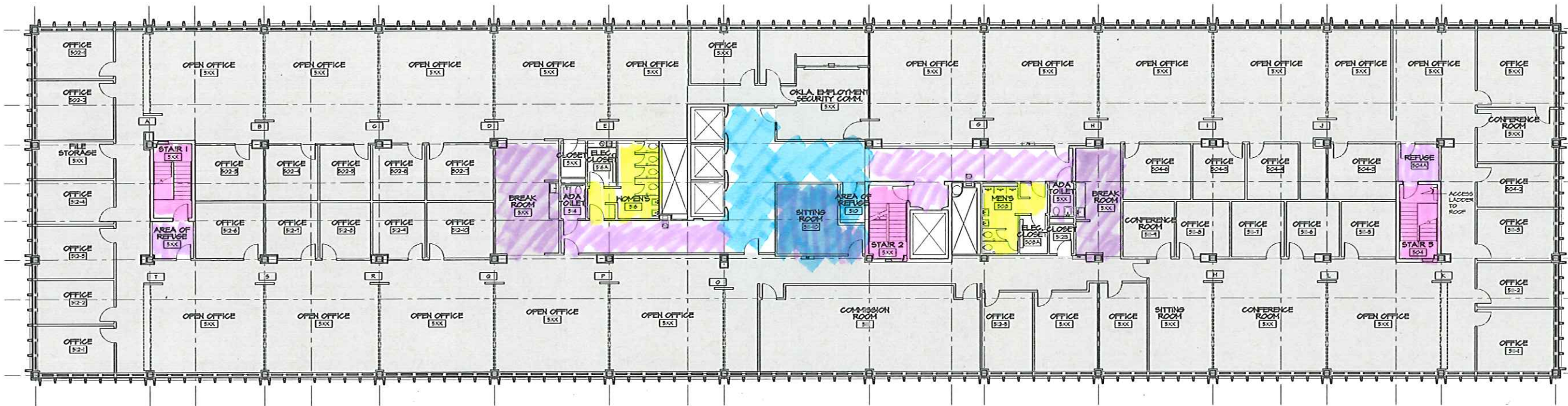

DEPARTMENT INDEX: 5TH FLOOR	
□ OESC	20,425 sqft
□ BUILDING SUPPORT	2,905 sqft
	23,330 sqft

B 5th FLOOR PLAN
SCALE: 3/32" = 1'-0"
NORTH 0 2 4 8 16 FEET

DEPARTMENT INDEX: 4TH FLOOR	
□ OESC	20,445 sqft
□ BUILDING SUPPORT	2,885 sqft
	23,330 sqft

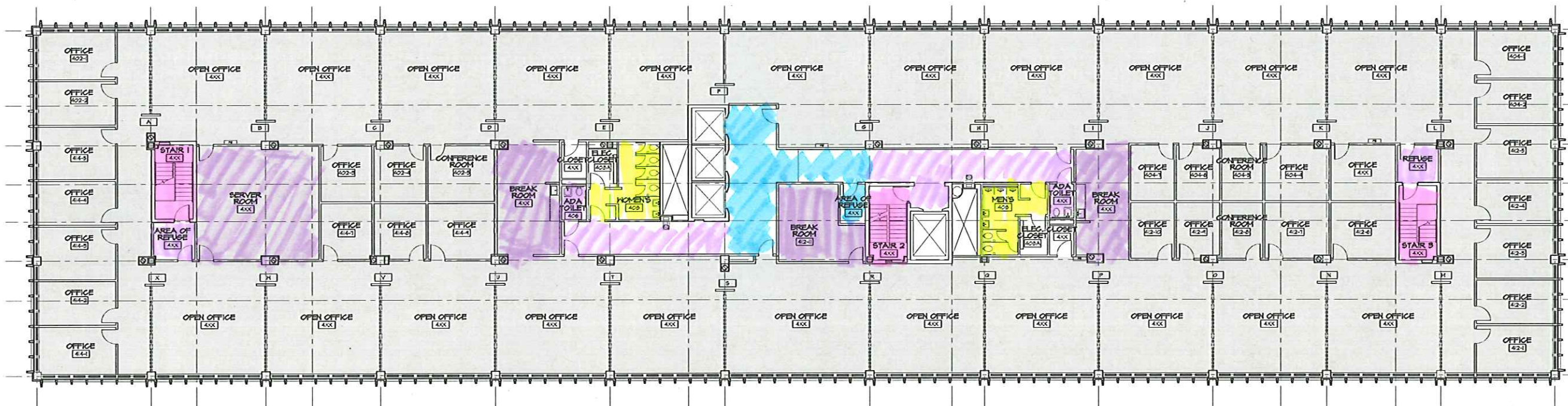

A 4th FLOOR PLAN
SCALE: 3/32" = 1'-0"
NORTH 0 2 4 8 16 FEET

Will Rogers
Existing Conditions
Oklahoma City, Oklahoma
Floor Plans

GH2 ARCHITECTS

320 South Boston, Suite 1600
Tulsa, OK 74103
T: 918.587.6158 GH2.COM
A SPECIALTY PRACTICE OF GH2 ARCHITECTS, LLC

INTERIM REVIEW
ONLY

DOCUMENT INCOMPLETE.
NOT INTENDED FOR PERMIT,
BIDDING OR CONSTRUCTION

ARCHITECT: THOMAS C. SEAT
LICENSE #: 4153

PROJECT #: 20120027.43

ISSUE DATES:
05/12/14 As-built Review

SHEET NUMBER:

A104

© 2015 COPYRIGHT GH2 ARCHITECTS, LLC